

# CLASSIC FREESTANDING SERIES

## DOOR FRAME

FREESTANDING HEAD

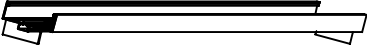

FACTORY APPLIED CORNER CLIPS

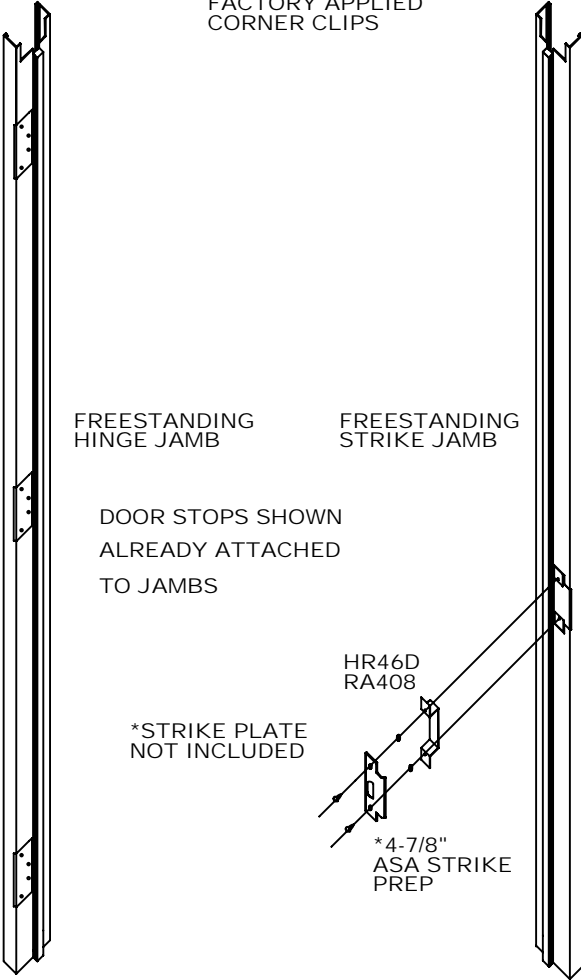

FREESTANDING HINGE JAMB

FREESTANDING STRIKE JAMB

DOOR STOPS SHOWN ALREADY ATTACHED TO JAMBS

HR46D RA408

\*STRIKE PLATE NOT INCLUDED

\*4-7/8" ASA STRIKE PREP

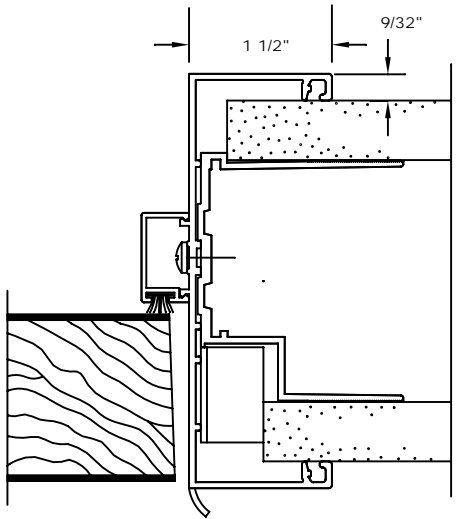
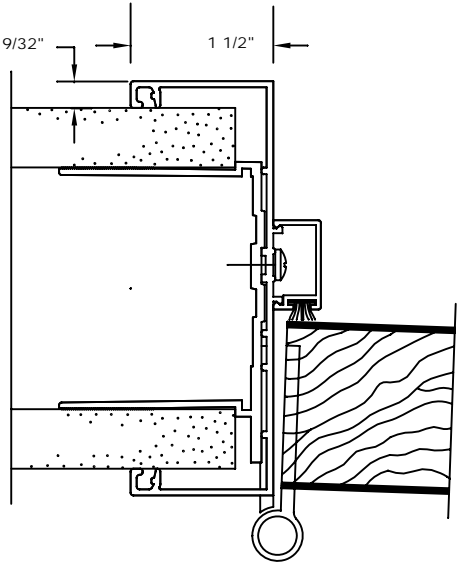
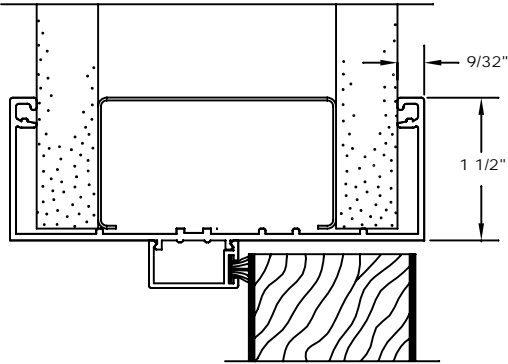

NOT TO SCALE

# CLASSIC Freestanding

## DRYWALL AT HEAD

### GENERAL INSTALLATION INSTRUCTIONS

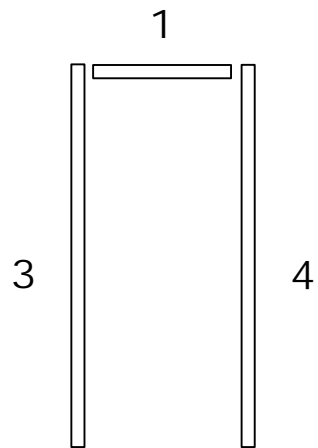

1. PLACE HEAD OVER DRYWALL. ADJUST TO DOOR OPENING HEIGHT AND LEVEL.
2. MEASURE AND CUT ALL VERTICALS.  
HINGE JAMB AND STRIKE JAMB ARE FLUSH WITH TOP OF HEAD.
3. PLACE HINGE JAMB OVER DRYWALL. ATTACH TO HEADER WITH CLIP.  
CONFIRM DOOR OPENING HEIGHT AND PLUMB HINGE JAMB.  
ATTACH HINGE JAMB TO WALL WITH DRYWALL SCREWS (BY OTHERS).  
SNAP ON DOOR STOP.
4. ATTACH STRIKE JAMB TO HEADER WITH CLIP.  
CONFIRM DOOR OPENING HEIGHT AND WIDTH. PLUMB STRIKE JAMB.  
ATTACH STRIKE JAMB TO WALL WITH DRYWALL SCREWS (BY OTHERS).  
SNAP ON DOOR STOP.

NOTE: IF JAMBS NEED TO BE CUT,  
TRIM BOTTOM OF JAMBS ONLY.

# Classic

## 5/8" DRYWALL CONSTRUCTION

Classic is an interior door frame and glazing system designed to fit over commercial drywall construction. The system is assembled into the rough opening left in the drywall and attached to the wall. Classic fits over three common drywall throat sizes. They are 2-1/4", 3-3/4" and 4-7/8" nominal wall thicknesses.

IMPORTANT:

WALL THICKNESS CANNOT EXCEED 1/16" THICKER THAN NOMINAL.

C-STUD INSET  
4" AT DOOR  
FRAME JAMBS

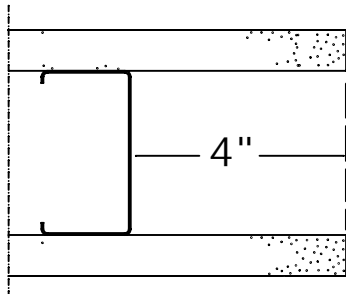

DOOR FRAME  
JAMB \*

C-STUD  
REVERSED

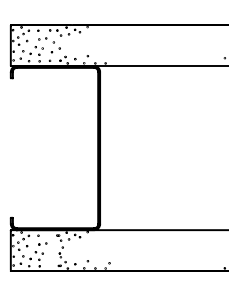

GLAZING  
JAMB \*\*

C-STUD  
REVERSED

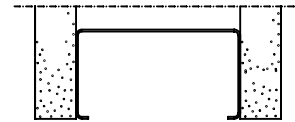

USE STANDARD  
C-STUD AT HEAD

HEAD \*\*



SILL \*\*

FOR 1/2" DRYWALL APPLICATION:

\* HOLD DOOR FRAME C STUD(S) BACK 10" AND FRAME MUST HAVE "SHIM STUDS".

\*\* GLAZING JAMB, HEAD AND SILL C STUDS REQUIRE SHIM BETWEEN STUD AND DRYWALL FOR CORRECT FIT.